

- - FOUND IRON PIN
- ⊗ - FOUND STONE
- ⊠ - RIGHT-OF-WAY MARKER
- ⊙ - 5/8" REBAR W/SCHAEFER CAP
- (M) - MEASURED
- (R) - RECORD
- (D) - DEED
- (GLO) - ORIGINAL GLO DISTANCE

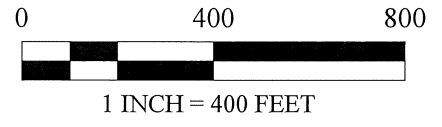

BEARINGS ARE MISSOURI CENTRAL GRID BASED ON GPS OBSERVATION

TRACT 2:
 A tract of land being part of the Northwest Quarter of the Southwest Quarter of Section 12, Township 55 North, Range 23 West of the fifth principal meridian, Carroll County, Missouri, being more particularly described as follows:
 Commencing at an iron rod marking the Northwest corner of the Southwest Quarter of said Section 12; thence along the North line of said Southwest Quarter, South 88 degrees 10 minutes 56 seconds East, a distance of 870.32 feet to an iron rod and the POINT OF BEGINNING; thence continuing South 88 degrees 10 minutes 56 seconds East, a distance of 437.11 feet to an iron rod at the Northeast corner of the Northwest Quarter of the Southwest Quarter of said Section 12; , South 00 degrees 23 minutes 13 seconds West, a distance of 1303.51 feet to an iron rod at the Southeast corner of the Northwest Quarter of the Southwest Quarter of said Section 12; thence North 88 degrees 17 minutes 30 seconds West, a distance of 1307.48 feet to an iron rod at the Southwest corner of the Northwest Quarter of the Southwest Quarter of said Section 12; thence along the West line of said Section 12, North 00 degrees 23 minutes 31 seconds East, a distance of 905.89 feet to an iron rod; thence South 88 degrees 10 minutes 56 seconds East, a distance of 425.37 feet to an iron rod; thence North 00 degrees 24 minutes 11 seconds East, a distance of 37.44 feet to an iron rod; thence South 88 degrees 10 minutes 56 seconds East, a distance of 444.87 feet to an iron rod; thence North 00 degrees 24 minutes 11 seconds East, a distance of 362.67 feet to the POINT OF BEGINNING, containing 31.5 acres. Subject to that part currently being used for public roadway and any easements of record or not of record, if any.

TRACT 3:
 A tract of land being part of the Northwest Quarter of the Southwest Quarter of Section 12, Township 55 North, Range 23 West of the fifth principal meridian, Carroll County, Missouri, being more particularly described as follows:
 Beginning at an iron rod marking the Northwest corner of the Southwest Quarter of said Section 12; thence along the North line of said Southwest Quarter, South 88 degrees 10 minutes 56 seconds East, a distance of 870.32 feet to an iron rod; thence South 00 degrees 24 minutes 11 seconds West, a distance of 362.67 feet to an iron rod; thence North 88 degrees 10 minutes 56 seconds West, a distance of 444.87 feet to an iron rod; thence South 00 degrees 24 minutes 11 seconds West, a distance of 37.44 feet to an iron rod; thence North 88 degrees 10 minutes 56 seconds West, a distance of 425.37 feet to an iron rod on the West line of said Section 12; thence North 00 degrees 23 minutes 31 seconds East, a distance of 400.11 feet to the POINT OF BEGINNING, containing 7.6 acres. Subject to that part currently being used for public roadway and any easements of record or not of record, if any.

CLIENT: DAVID KIMZEY & REBECCA BROZOVICH
 DATE OF SURVEY: MARCH 3, 2025
 ACCURACY CLASS: RURAL PROPERTY

ALL DISTANCES AND AREAS SHOWN ARE BASED ON GROUND MEASUREMENTS. PROJECT SCALE FACTOR FOR MISSOURI CENTRAL GRID NAD 83 IS 0.99997981.

REFERENCE SURVEYS:
 1868; SRB F, PG 315; SHELLES
 1997; DOC#600-59778; KLIETHERMES, PLS#2109.
 2020; SLD 313; MAGEE, PLS#2136.
 2007; SLD 313; MAGEE, PLS#2136.

SURVEYORS STATEMENT
 A survey of the property shown hereon has been performed to the best of my knowledge and belief in accordance with the current Missouri Standards for Property Boundary Surveys.

John H. Schaefer,
 Missouri P.L.S.#2005000079

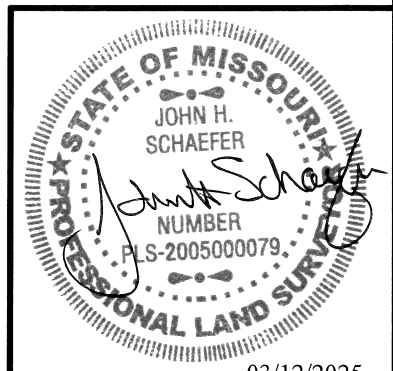

FIELD: MGW | DRAWN: WJS | PROJECT #25-074
 SURVEY CERTIFICATE OF AUTHORITY LS-2009021550

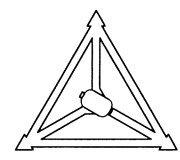

SCHAEFER
 SURVEYING, LLC

John H. Schaefer, PLS
 30638 Kenbrook Pl.
 Macon, MO 63552
 PHONE: 660-395-5942
 EMAIL: john@schaefersurveying.com

BOUNDARY SURVEY

NW 1/4 SW 1/4 SEC. 12, T55N, R23W
 CARROLL COUNTY, MISSOURI

03/12/2025